

CARATTERISTICHE

Temperatura ambiente	-10 ÷ +45 °C	
Fluido	aria filtrata 50 µm, con o senza lubrificazione	
Sistema di commutazione	sistema spola	
Pressione Max	10 bar	
Conessioni	G/18	G1/4
Diametro nominale (mm)	6,5	8,5
Portata nominale (NI/min)	890	1480
Corpo valvola	zama pressofusa (G1/8), alluminio (G1/4)	
Guarnizioni	gomma nitrilica	
Spola	alluminio	
Elettropilota/Bobina	serie AA/U1-U3	
Assorbimento	3,5 W (DC) - 5 VA (AC)	
Connettore	AM 5110	
Tensione	12 V DC - 24 V DC - 24 V AC - 110 V AC - 230 V AC	
Comando manuale	a vite 2 posizioni	



NOTA: per alcune versioni sono disponibili su richiesta guarnizioni per alta temperatura (per informazioni rivolgersi al nostro Ufficio Commerciale)

Modularità sistema UNIVERSAL

MECCANICO

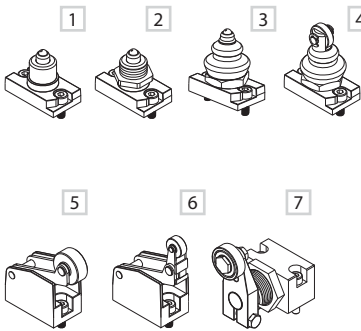

MANUALE

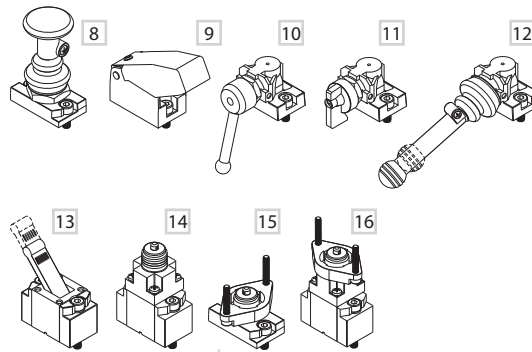

ELETTRICO

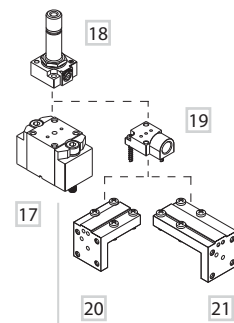

PNEUMATICO

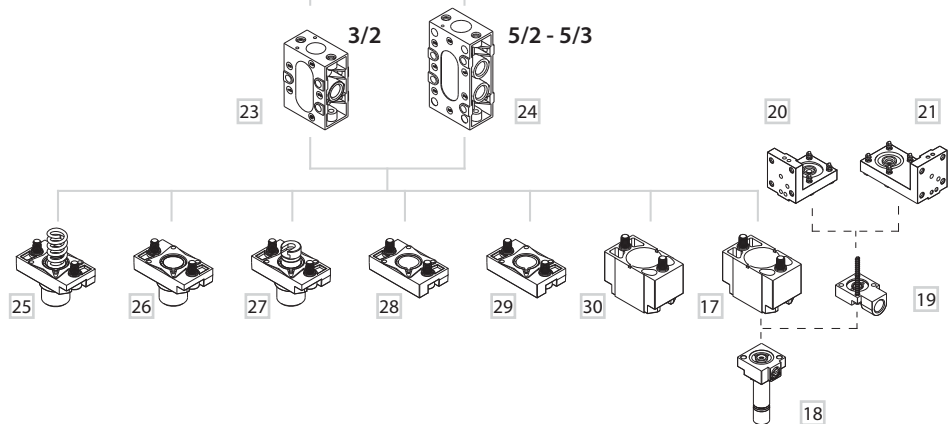
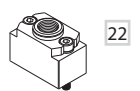

COMANDO MECCANICO

- 1 Puntale a sfera
- 2 Puntale a sfera con montaggio a vite su quadro
- 3 Puntale a sfera con protezione antipolvere
- 4 Puntale a rullo con protezione antipolvere
- 5 Leva rullo
- 6 Leva rullo unidirezionale
- 7 Leva a rullo laterale bidirezionale

COMANDO MANUALE

- 8 Tiretto
- 9 Tasto
- 10 Leva rotante
- 11 Selettore

- 12 Leva a 90° corta/lunga
- 13 Leva corta/lunga
- 14 Azionamento indiretto filettato
- 15 Azionamento diretto da quadro
- 16 Azionamento indiretto da quadro

COMANDO ELETTRICO

- 17 Elettrico amplificato
- 18 Elettropilota U1
- 19 Piastrina per servoalimentazione esterna
- 20 Squadretta variante solenoide "H"
- 21 Squadretta variante solenoide "P"

COMANDO PNEUMATICO

- 22 Pneumatico amplificato

CORPO

- 23 Corpo 3/2
- 24 Corpo 5/2

RITORNO

- 25 Molla meccanica
- 26 Pneumatico non amplificato
- 27 Fondello 2/3 posizioni
- 28 Fondello
- 29 Molla pneumatica
- 30 Pneumatico amplificato

Valvole ad azionamento meccanico diretto G1/8

Leva rullo

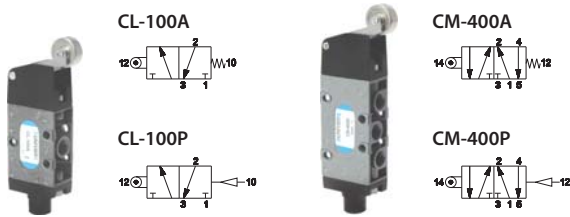

Leva rullo unidirezionale

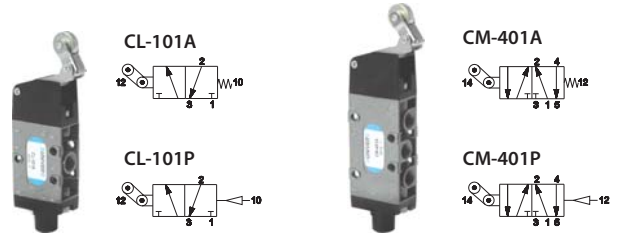

NEW - Leva rullo laterale bidirezionale

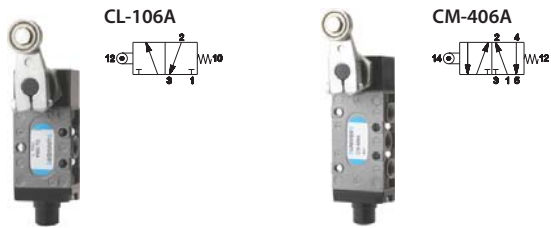

NEW - Leva rullo laterale bidirezionale regolabile

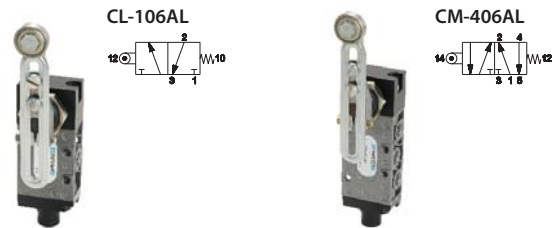

Puntale a sfera

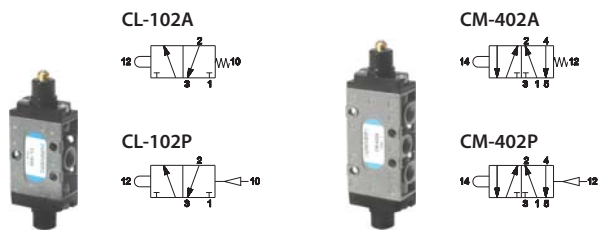

Puntale a rullo con protezione antipolvere

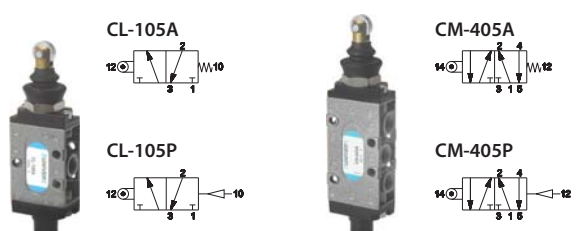

Puntale a sfera con protezione antipolvere

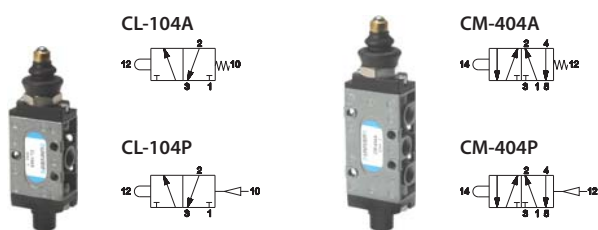

Puntale a sfera con montaggio a vite su quadro

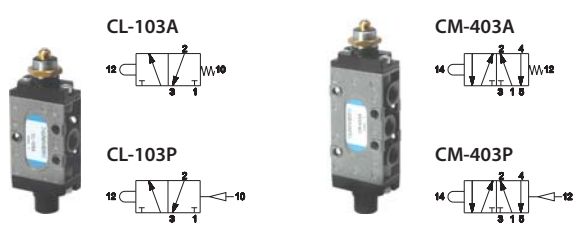

Valvole ad azionamento meccanico diretto G1/4

Puntale a sfera

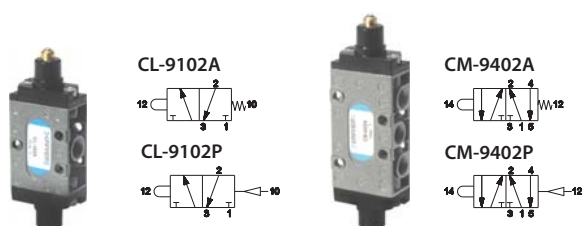

Puntale e sfera con montaggio a vite su quadro

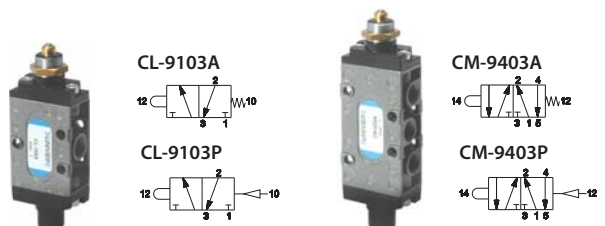

Valvole ad azionamento manuale G1/8

■ Tiretto

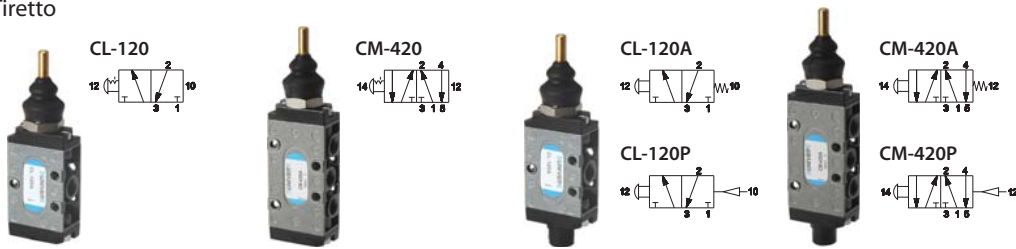

Le valvole sono fornite senza dispositivo



- GIALLO CP-911G
- ROSSO CP-911R
- NERO CP-911N
- VERDE CP-911V

■ Leva lunga

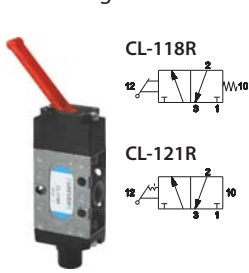

■ Leva corta

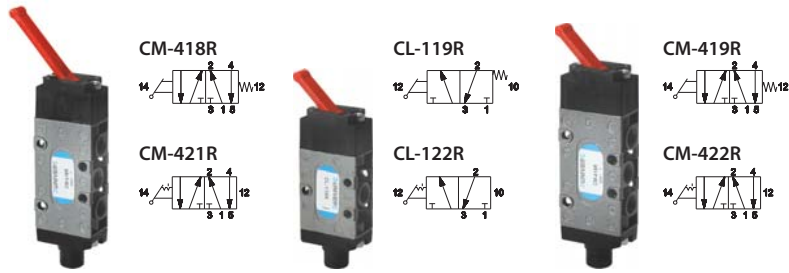

LEVA LUNGA

- DI SERIE
■ ROSSO

- SU RICHIESTA
■ GIALLO
■ NERO

LEVA CORTA

- DI SERIE
■ ROSSO

- SU RICHIESTA
■ GIALLO
■ NERO
■ VERDE

■ Tasto

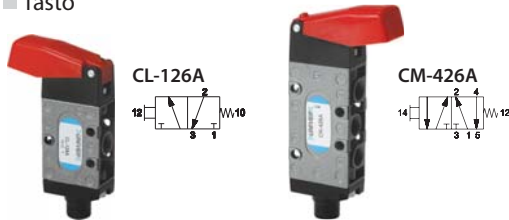

DI SERIE

- ROSSO

■ Leva rotante



- ROSSO CP-915R



- ROSSO CP-916R

Le valvole sono fornite senza dispositivo

■ Leva a 90° - 3 posizioni

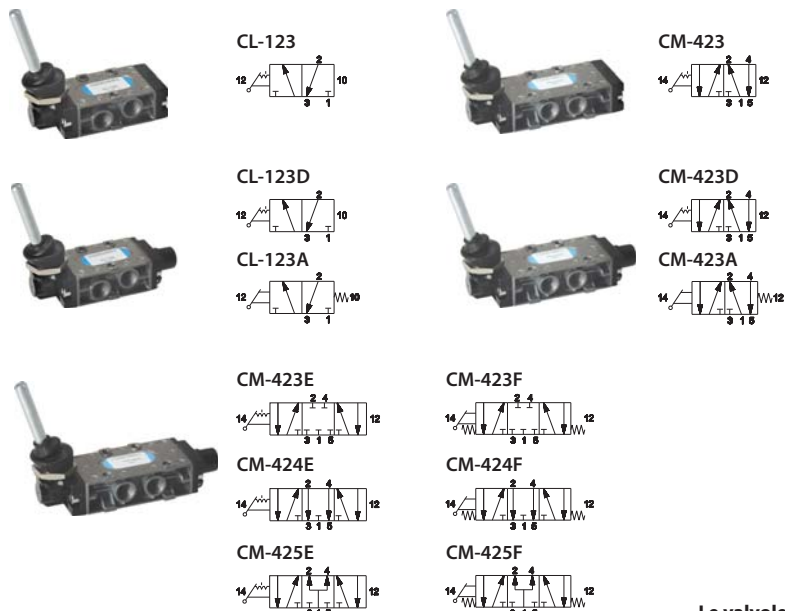

LEVA CORTA



- GIALLO CP-912G
■ ROSSO CP-912R
■ NERO CP-912N

LEVA LUNGA



- ROSSO CP-913R

Le valvole sono fornite senza dispositivo

Valvole ad azionamento manuale G1/4

■ Tiretto

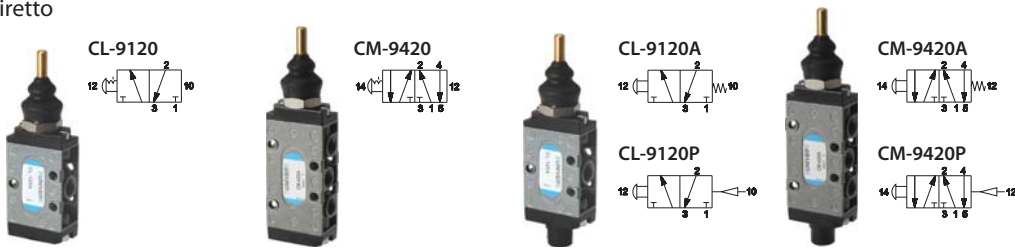

Le valvole sono fornite senza dispositivo



- GIALLO
CP-911G
- ROSSO
CP-911R
- NERO
CP-911N
- VERDE
CP-911V

■ Leva lunga

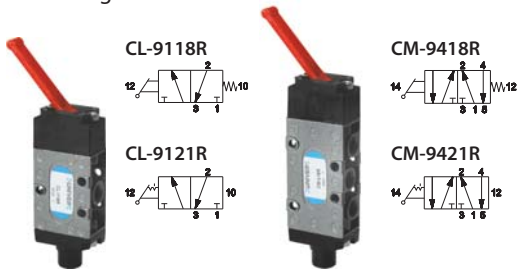

DI SERIE
■ ROSSO

SU RICHIESTA
■ GIALLO
■ NERO

■ Leva rotante



■ ROSSO
CP-915R



■ ROSSO
CP-916R

Le valvole sono fornite senza dispositivo

■ Leva a 90° - 3 posizioni

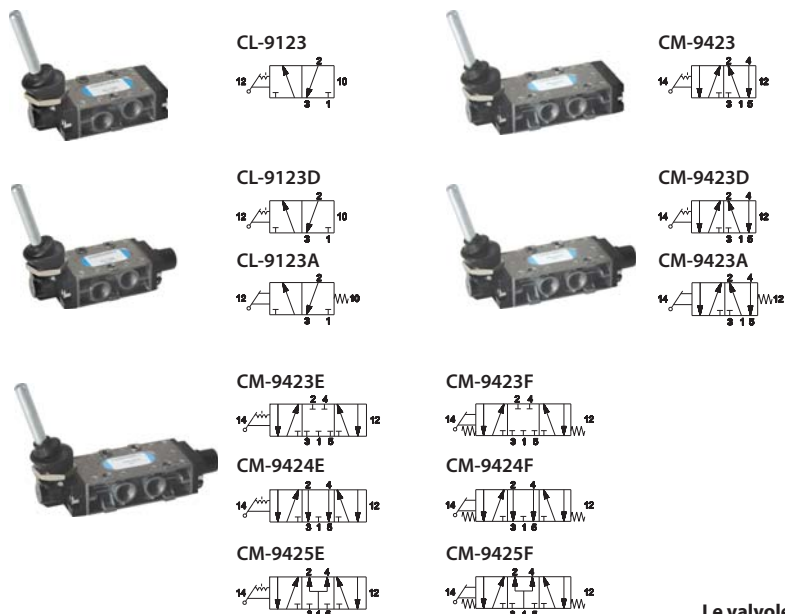

LEVA CORTA



■ GIALLO
CP-912G

■ ROSSO
CP-912R

■ NERO
CP-912N

LEVA LUNGA



■ ROSSO
CP-913R

Le valvole sono fornite senza dispositivo

Valvole ad azionamento pneumatico G1/8 - G1/4

■ Singolo impulso



CL-200 G1/8
CL-9200 G1/4

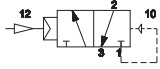

CL-203 G1/8
CL-9203 G1/4

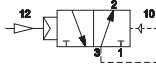

CL-200A G1/8
CL-9200A G1/4

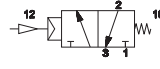

CM-500 G1/8
CM-9500 G1/4

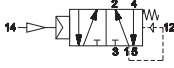

CM-500A G1/8
CM-9500A G1/4

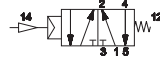

■ Doppio impulso



CL-220 G1/8
CL-9220 G1/4



CL-221 G1/8
CL-9221 G1/4



CL-224 G1/8
CL-9224 G1/4



CM-521 G1/8
CM-9521 G1/4

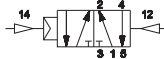

CM-524 G1/8
CM-9524 G1/4

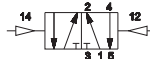

CM-520 G1/8
CM-9520 G1/4

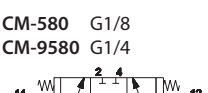
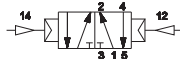

CM-580 G1/8
CM-9580 G1/4

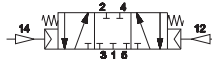

CM-585 G1/8
CM-9585 G1/4

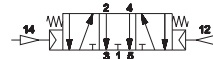

CM-590 G1/8
CM-9590 G1/4

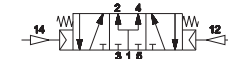

Valvole ad azionamento elettrico G1/8 - G1/4

■ Singolo impulso



CL-300 G1/8
CL-9300 G1/4

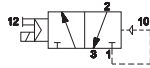

CL-302A G1/8
CL-9302A G1/4

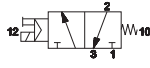

CL-301 G1/8
CL-9301 G1/4

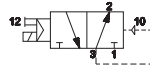

CL-303A G1/8
CL-9303A G1/4

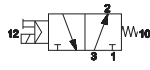

CM-600 G1/8
CM-9600 G1/4

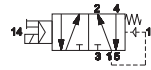

CM-602A G1/8
CM-9602A G1/4

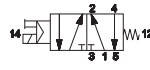

■ Doppio impulso



CL-320 G1/8
CL-9320 G1/4

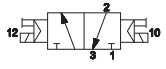

CL-321 G1/8
CL-9321 G1/4

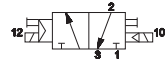

CL-322 G1/8
CL-9322 G1/4

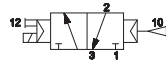

CM-620 G1/8
CM-9620 G1/4

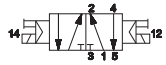

CM-621 G1/8
CM-9621 G1/4

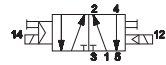

CM-622 G1/8
CM-9622 G1/4

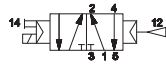

CM-680 G1/8
CM-9680 G1/4

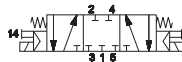

CM-685 G1/8
CM-9685 G1/4

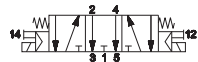

CM-690 G1/8
CM-9690 G1/4

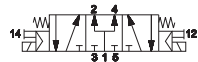

Le elettrovalvole sono fornite senza bobine, connettori e ghiera di bloccaggio

AM-5148

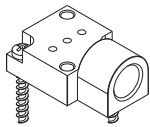

Piastrina per servoalimentazione esterna

AM-5151

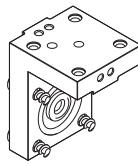

Squadretta variante solenoide "H"

AM-5152

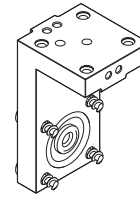

Squadretta variante solenoide "P"

Sottobase modulare CLIPS G1/8 - G1/4 per valvole 3/2 - 5/2 - 5/3



G1/8



G1/4

CP-100/CP-9100

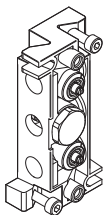

sottobase modulare scarichi regolati e convogliati
CP-100 per G1/8, **CP-9100** per G1/4
 materiale: zama

Di serie: viti, guarnizioni, regolatore scarichi e raccordo di fissaggio valvole

CP-101/CP-9101

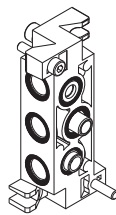

sottobase modulare senza scarichi regolati
CP-101 per G1/8, **CP-9101** per G1/4
 materiale: zama

Di serie: viti, guarnizioni e raccordo di fissaggio valvole

CP-105/CP-9105

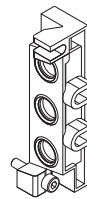

piastra di entrata connessioni laterali
 connessione: **CP-105** G1/4, **CP-9105** G3/8
 materiale: zama

Di serie: viti e guarnizioni

CP-106



piastra posto valvola inutilizzata
 materiale: alluminio

CP-110/CP-9110



raccordo
 connessione: **CP-110** G1/8, **CP-9110** G1/4
 materiale: ottone

CP-111/CP-9111



separatore pressioni differenziali
CP-111 per G1/8, **CP-9111** per G1/4
 materiale: alluminio

CP-112/CP-9112



tappo per montaggio valvola 3/2
CP-112 per G1/8, **CP-9112** per G1/4
 materiale: alluminio

CP-113/CP-9113



spillo di regolazione
CP-113 per G1/8, **CP-9113** per G1/4
 materiale: ottone

Per ogni pressione supplementare richiedere un raccordo più due separatori.

Tappo per montaggio valvole 3/2 NC-NO su sottobase "CLIPS" per chiudere la via inutilizzata. Sottobase di serie con vite di regolazione taglio a cacciavite. A richiesta spillo di regolazione con impugnatura zigrinata.

■ Esempio di assemblaggio batteria 3 pressioni

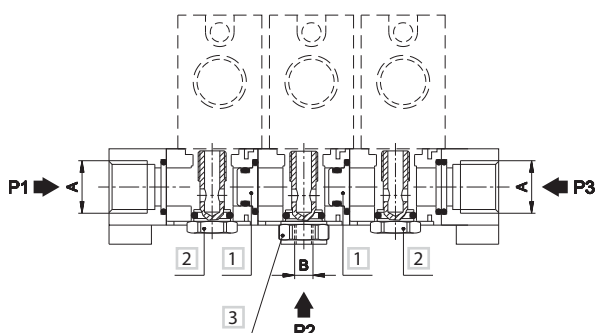

	A	B
G1/8	G1/4	G1/8
G1/4	G3/8	G1/4

- 1 Separatore pressioni differenziali CP-111/CP-9111
- 2 Raccordo fissaggio valvola inglobato nella sottobase
- 3 Raccordo CP-110/CP-9110