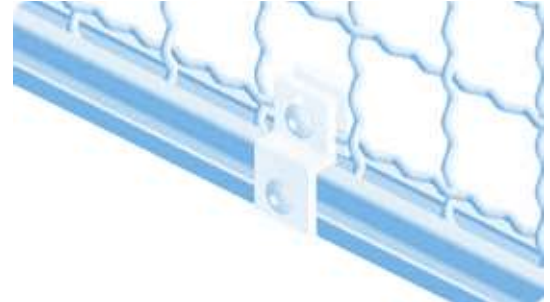
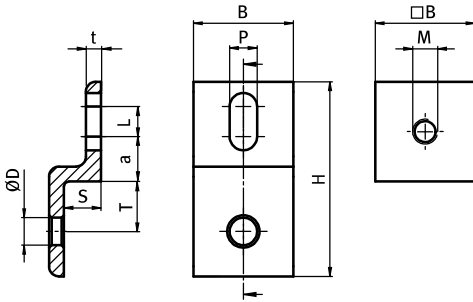

## GITTERHALTER

## WIRE MESH PANEL HOLDER

**Ausführung** Aluminium, mit Halteplatte**Model** Aluminum, with backing plate**Beschreibung** zur einfachen Befestigung von Flächenelementen an Aluminiumprofilen**Description** To attach panels easily to aluminum profiles**Material** Aluminium**Material** Aluminum**Liefereinheit** 10 Stück**Pack Quantity** 10 pieces

Gitterhalter Wire Mesh Panel Holder	B [mm]	H [mm]	L [mm]	M	P/D [mm]	S [mm]	T [mm]	für Profil For Profile	Gewicht [g] Weight [g]	Teil-Nr. Part #
	20.0	39.0	6.0	M5	5.5	7.4	10.0	20	14.5	<b>093P20LN</b>
	30.0	68.0	10.0	M8	9.0	11.0	15.0	30	41.4	<b>093P30LN</b>
	40.0	78.0	13.5	M8	9.0	16.0	20.0	40	82.0	<b>093P40LN</b>
	45.0	88.0	18.0	M8	9.0	17.5	22.5	45	105.0	<b>093P45LN</b>